

HANDYLIFT HYDRAULIC

04/21 | Doc. 005



Distributed by:



TECHNICHE

TECHNICHE TRADING LLC

PO Box 393135, Dubai, UAE

www.techniche.ae | sales@techniche.ae | 055 5590438

Proteus Equipment

Innovative products for demanding environments

HYDRAULIC LIFTERS



Proteus has been the market leader in providing manhole cover lifters for over 30 years, and our UK-made hydraulic models are the best in the business, allowing a single person to quickly and safely remove even the heaviest, most stubborn covers.

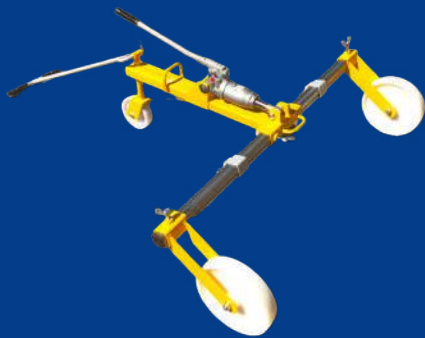

**HANDYLIFT
HYDRAULIC**

- 1.5 tonne Safe Working Load
- To suit covers up to 900x900mm keyspan
- Keys sold separately
- Our best-selling and most versatile lifter



**TEXAS
HYDRAULIC**

- 1.5 tonne Safe Working Load
- To suit covers up to 1200x1200mm keyspan
- Keys sold separately
- A physically larger version of the HandyLift Hydraulic, for bigger covers

For extra large or heavy covers

ULTRA-DUTY

Even the biggest, heaviest covers from Cubis or Elkington Gatic will be no problem for an Ultra-Duty spec lifter, featuring a thicker beam and varying body lengths



- Thicker 50mm beam to avoid flexing on very heavy covers or large wheelspans
- To suit covers up to 900x900mm keyspan (Handylift), 1200x1200mm (Texas), or 1500x1500mm (Super Texas - pictured)
- Keys sold separately

**HANDYLIFT
ULTRA-DUTY**

**TEXAS
ULTRA-DUTY**

**SUPER TEXAS
ULTRA-DUTY**

KEYS FOR HYDRAULIC LIFTERS



For split 'double-triangle' covers

SWIVEL-RING

For split covers with a keyhole in each half, use this accessory. It locks the halves together and lifts them as one.



1 - Lock the Swivel-ring down on the cover and tighten the keys

2 - Attach to one of the lifter's hook boxes and proceed to lift



SWIVEL-RING LOCKER SPREADER

- Plated swivelling bar used to lift split double-triangle manhole covers
- The swivel-ring locks the two halves of the cover together for safer, faster lifting
- Comes with two integrated 35x8mm keys

For single-piece covers with 2 keyholes

RINGTOP KEYS

If your manhole covers have just two keyholes in, you will need to choose suitable keys from this section to go with your hydraulic lifter



1 - Insert the keys into the keyholes, then rotate 90 degrees to lock in place

2 - Engage the lifter's hook boxes with the loops on the keys, and proceed to lift



- **Type 1** - These keys have a 25x8mm 'T' lug at the bottom, to suit keyholes slightly larger than this
- **Type 2** - These keys have a 35x8mm 'T' lug at the bottom. Type 2 are the most commonly required size - if in doubt, they are the safest bet
- **Type 4** - Featuring a 50x12mm 'T' lug at the bottom, and a long stem for recessed covers. It is quite unusual to find covers that need this key type
- **Type 5** - These keys have a 35x12mm 'T' lug at the bottom, to suit keyholes that are a bit too wide for a Type 2
- **Type HDH** - These have a 12mm round hook to suit gulleys or grates

RINGTOP KEYS (PER SET)

A set includes four keys; two with lugs parallel to the loop, and two with lugs perpendicular to the loop

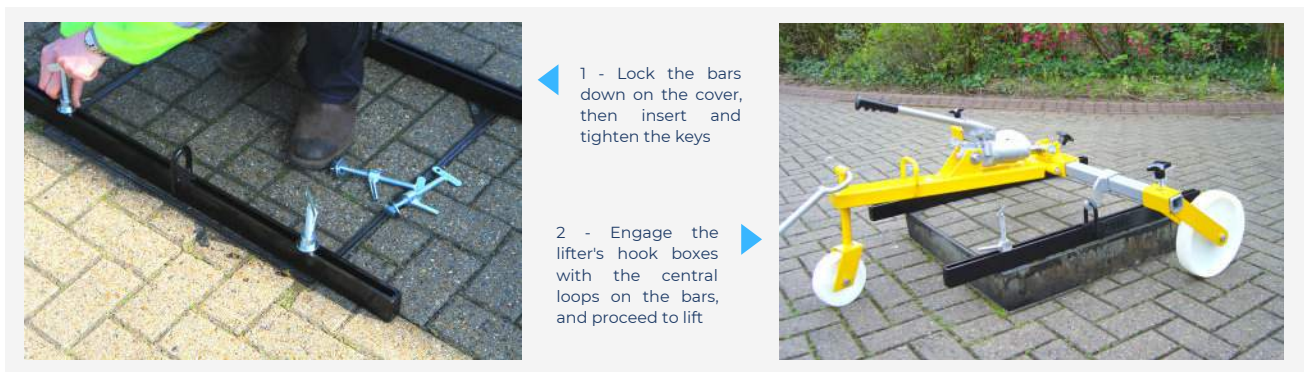

- A pair of lifting bars complete with four interchangeable keys, to lift 4-keyhole covers
- The size refers to the max distance between keyholes. 900mm bars are for use with the Handylift Hydraulic; 1100 & 1200mm are used with the Texas
- A set of four keys is included with your bars - see page 8 to choose the type

900mm

1100mm

1200mm



- A pair of lifting bars complete with four interchangeable keys, to lift 4-keyhole covers
- Combines the functionality of regular spreader bars with a secondary lifting loop and jack bolt to break the seal on tapered Elkington Gatic-style covers
- A set of four keys is included with your bars - see page 8 to choose the type

900 mm

1100 mm

1200 mm

For use with Spreader & Universal bars

SPREADER KEYS

Your bars will come with a set of four keys, which you can choose from this selection, but if you have a multitude of 4-key covers to lift then you may need additional types

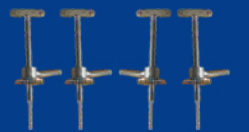

- **25x8mm** - These have a small lug to fit keyholes around 30x12mm or thereabouts
- **35x8mm** - These have a slightly larger T-shaped lug and are the most common size required for standard block-paved or concrete in-filled covers
- **Gatic** - Used with Universal bars to lift Elkington Gatic-style covers
- **Foot** - Typically used on internal covers in hospitals and shops, where the cover has four round, non-threaded holes
- **Threaded** - For covers with four threaded holes, normally found indoors. Available in M8, M10, M12, M14 and M16 sizes
- **Hook** - Usually used on gulleys or grates

SPREADER KEYS (PER SET)

A set = four keys. One set is included with the bars, then you can buy additional sets if needed

SWINGER LIFTERS



If you still want a single-person lifter to take the strain out of lifting manhole covers, but don't have any large 4-key covers to lift, our Swinger models will do just the job. Designed for 2-key covers, including those split diagonally into two halves, they are powerful yet easy to carry.



**HANDYLIFT
SWINGER**

- 1.0 tonne Safe Working Load
- To suit covers up to 600x600mm keyspan
- Includes a pair of keys - see page 10 for options
- Built to last - Heavy duty construction with durable hi-tensile steel screwjacks & bearings



**HANDYLIFT
SWINGER XL**

- 1.0 tonne Safe Working Load
- To suit covers up to 800x800mm keyspan
- Includes a pair of keys - see page 10 for options
- A physically bigger version of the Handylift Swinger, with even larger versions available on request



For BT carriageway style covers

SWINGER BT SPEC

Tackle BT carriageway covers with ease, using this special kit designed to lift them quickly, simply and safely

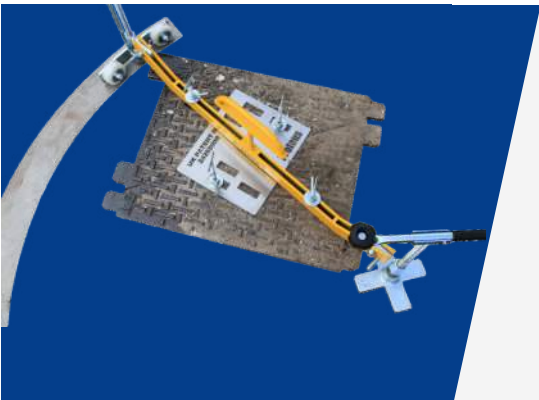

- Complete with accessory pack designed for lifting BT carriageway covers
- Pack contains arced wheel runners, patented BT locking plate, and four 35x10mm keys - see below for additional pairs of keys
- Built to last - Heavy duty construction with durable hi-tensile steel screwjacks and bearings

**HANDYLIFT SWINGER
BT SPEC**

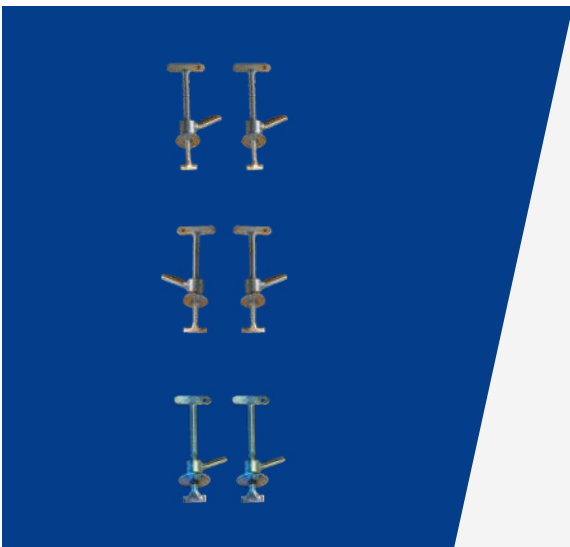

- **25x8mm** - These have a small lug to fit keyholes around 30x12mm or thereabouts
- **35x8mm** - These have a slightly larger T-shaped lug and are the most common size required for most covers. Unless another size is specified, the Swinger lifter will come with a pair of these included
- **35x10mm** - For keyholes where a 35x8mm would be a little too narrow

**SWINGER KEYS
(PER SET)**

A set = two keys. One set is included with the lifter, then you can buy additional sets if needed



PRISTINE KEY



pristine
condition
international



If you want a set of manual lifting keys for two-person lifting, this product combines Proteus' experience of lifting manhole covers, with the extensive manual handling knowledge of health & safety experts Pristine Condition International.



- Two-person lifting kit designed for the water industry by health & safety specialists Pristine Condition International
- Adjustable handles to enable safe lifting with operatives of differing heights
- Comes with keyhole protectors, locking plates, three pairs of interchangeable heavy-duty key ends, and optional storage

NO STORAGE

BRANDED STORAGE BAG
WITH ZIP FASTENING

BRANDED STORAGE BRIEFCASE WITH FOAM INSERT

OTHER LIFTERS



Requiring neither strength nor skill, the HandyLift Wheeler is an alternative model for 2-key covers. It utilises a telescopic handle and sturdy screwjacks to provide maximum manual leverage with minimal physical effort.

The Gully Lifter is not a true lifter, but is designed more as a seal breaker for stuck gully covers. These are not usually heavy and can normally be lifted by hand - however they do tend to get firmly stuck over time. This unit will free those jammed covers, enabling safe lifting thereafter.



**HANDYLIFT
WHEELER**

- 1.0 tonne Safe Working Load
- To suit covers up to 650x650mm keyspan
- Comes with a set of Type 2 Ringtop keys. For extra keys see Ringtop keys (page 5) or, for split covers, a Swivel-ring (page 4)
- Features powerful screwjacks to break the seal on stuck covers



GULLEY LIFTER

- Seal breaker for stuck gulleys and grates
- Durable construction, with an extra thick main beam and hi-tensile screwjacks
- Comes with two heavy-duty gully keys

ACCESSORIES FOR STORAGE



- A spring-loaded clip to store up to 20 Handylift keys
- Keys sold separately

KEY CLASP



- Bespoke 123 x 41 x 26cm aluminium storage chest with four carry handles
- Larger 167 x 41 x 26cm size for Texas / Texas Ultra-Duty models

STANDARD ALUMINIUM STORAGE CASE

TEXAS ALUMINIUM STORAGE CASE



- Tough, durable duffle bag with zip fastening and carry handles
- Suits all Handylift models

ASTRO-NYLON STORAGE BAG

ACCESSORIES

FOR SAFETY AND CONVENIENCE



**COPPER
COVER HAMMER**

- Used for hitting the edges of covers while under strain, in order to break the seal and pop the cover out
- Copper faces prevent sparks - ideal for conducting gas tests



KEYHOLE GOUGER

- Used for removing dirt and debris from keyholes
- Kinked end gets into those hard-to-reach areas

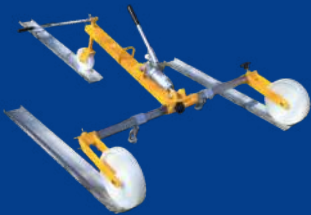

**U-CHANNEL
WHEEL RUNNERS**

- A set of wheel runners to provide stability when lifting on soft or uneven terrain
- Suits all hydraulic models



**ARCED
WHEEL RUNNERS**

- A set of steel wheel runners to give a smoother swinging action on rough ground
- Suits all Swinger models